

**AUBIN HALL
FIRST FLOOR**

Please Note: The gender and program assignment of Aubin suites and rooms changes from year to year based on numbers, class gender breakdowns, numbers in room selection processes, etc. For example, though women live in a particular suite one year, men may live in the same suite the following year; though a suite may be selected during the Honors Housing process one year, it may be used for the Singles process the following year.

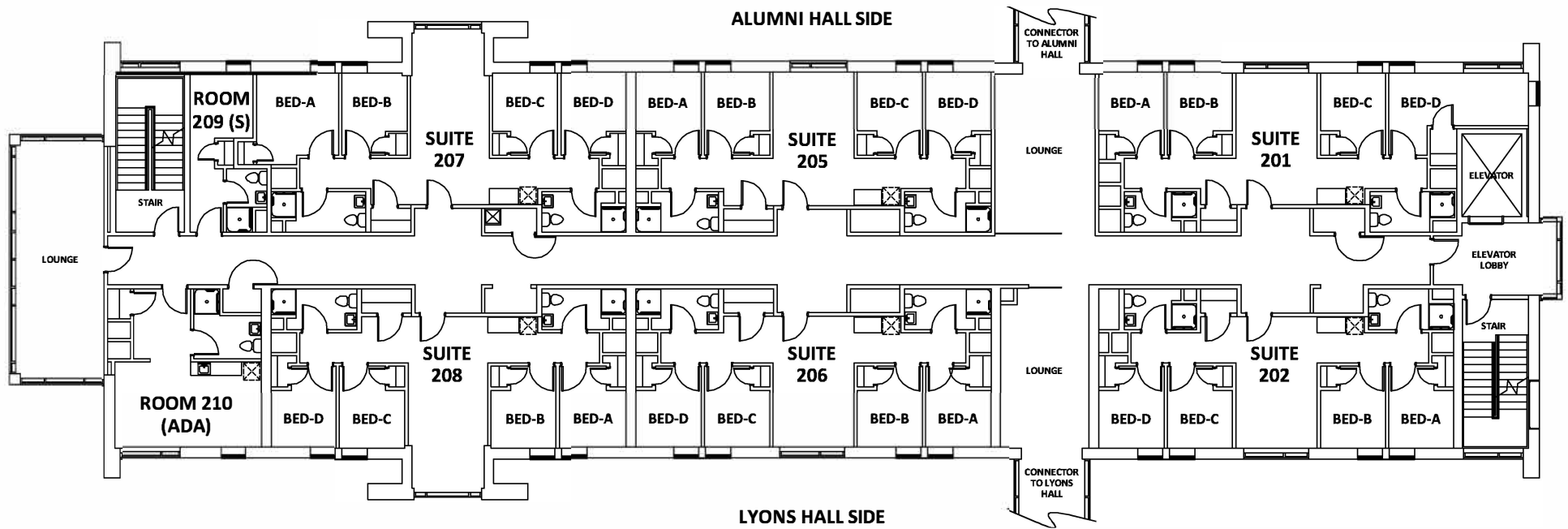

**AUBIN HALL
SECOND FLOOR**

Please Note: The gender and program assignment of Aubin suites and rooms changes from year to year based on numbers, class gender breakdowns, numbers in room selection processes, etc. For example, though women live in a particular suite one year, men may live in the same suite the following year; though a suite may be selected during the Honors Housing process one year, it may be used for the Singles process the following year.

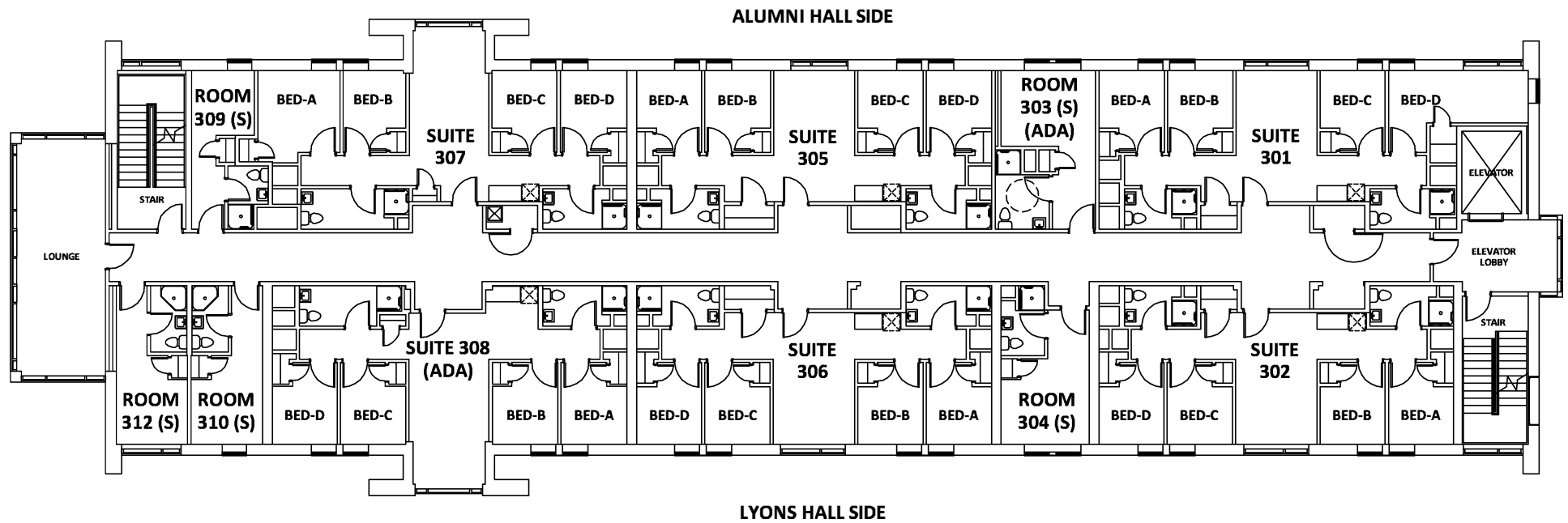

**AUBIN HALL
THIRD FLOOR**

Please Note: The gender and program assignment of Aubin suites and rooms changes from year to year based on numbers, class gender breakdowns, numbers in room selection processes, etc. For example, though women live in a particular suite one year, men may live in the same suite the following year; though a suite may be selected during the Honors Housing process one year, it may be used for the Singles process the following year.

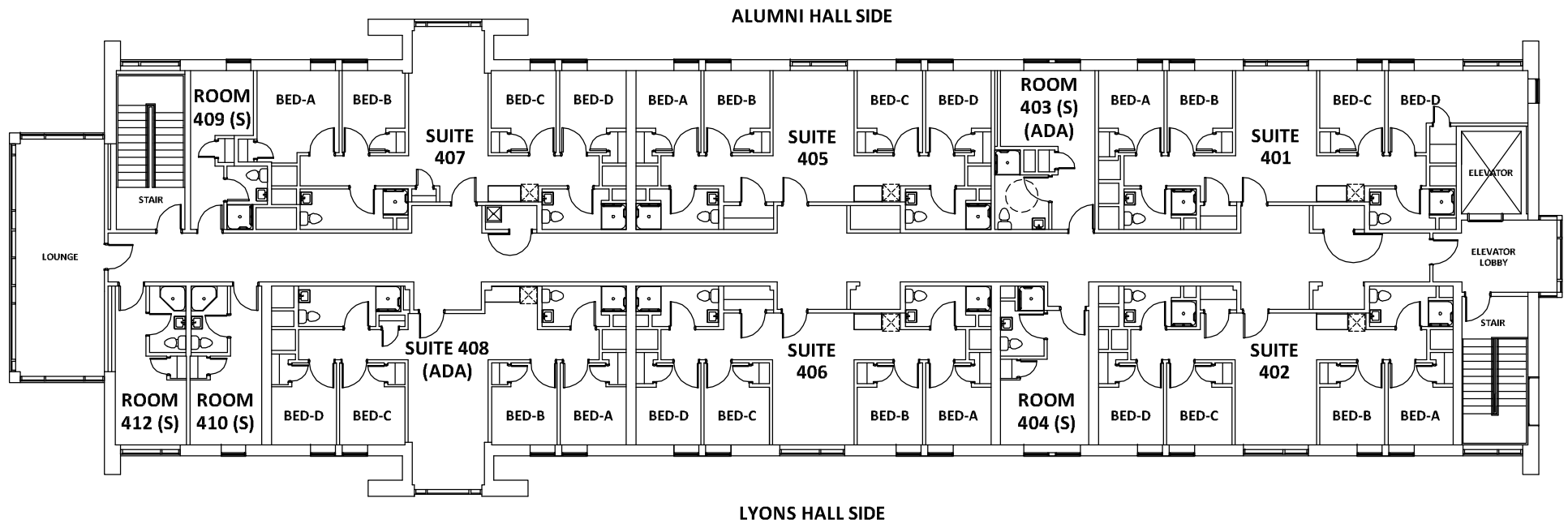

**AUBIN HALL
FOURTH FLOOR**

Please Note: The gender and program assignment of Aubin suites and rooms changes from year to year based on numbers, class gender breakdowns, numbers in room selection processes, etc. For example, though women live in a particular suite one year, men may live in the same suite the following year; though a suite may be selected during the Honors Housing process one year, it may be used for the Singles process the following year.